



# Sri Indu Institute of Engineering & Technology

Recognized Under 2(f) of UGC Act 1956

Approved by AICTE, New Delhi

Affiliated to JNTUH, Hyderabad

## 4.1.1- INFRASTRUCTURE AND PHYSICAL FACILITIES FOR TEACHING AND LEARNING

### INDEX

S. No.	Particulars
1	SUMMARY SHEET OF INFRASTRUCTURE AND PHYSICAL FACILITIES
2	A BLOCK – BUILDING PLAN
3	B BLOCK – BUILDING PLAN
4	D BLOCK – BUILDING PLAN
5	LAND DOCUMENTS
6	MASTER PLAN OF THE CAMPUS
7	GEO-TAGGED CLASS ROOMS AND LABORATORIES PHOTOS
8	GEO-TAGGED AUDITORIUM PHOTOS
9	GEO TAGGED CANTEEN PHOTOS
10	GEO TAGGED GIRLS HOSTEL PHOTOS

  
PRINCIPAL  
Sri Indu Institute of Engineering & Tech.  
Sheriguda(V), Ibrahimpatnam(M),  
R.R. Dist. Telangana -501 510



## **Sri Indu Institute of Engineering & Technology**

Recognized Under 2(f) of UGC Act 1956

Approved by AICTE, New Delhi

Affiliated to JNTUH, Hyderabad

**4.1.1 The Institution has adequate infrastructure and physical facilities for teaching- learning. viz., classrooms, laboratories, computing equipment etc**

### **Department of Mechanical Engineering**

#### **Class Rooms:**

The Department of Mechanical Engineering has 4 spacious class rooms fully equipped with latest audio-visual aids to make teaching interactive and interesting. Out of 4 class rooms 4 class rooms are equipped with ICT enabled facilities such as LCD projectors, smart interactive board and Wi-Fi and 2 tutorial classes are available.

#### **Laboratories:**

There are 13 Laboratories in the Department that are equipped with adequate number of laboratory equipment. Students are allowed to carry out mini projects and major projects in the respective laboratories in different time slots.

#### **Computing Equipments:**

The institution has adequate no of computers, laptops, printers, scanners, servers and CC cameras to facilitate computing, internet browsing and surveillance.

#### **Internet and WI-FI:**

The institution is completely enabled with Wi-Fi facility and the institution has upgraded its internet speed to 100 Mbps through leased line

#### **Library:**

The Mechanical Engineering Department is has collection of Text Books, Reference Books in the Departmental Library to meet the needs of students. Department library provides reference facilities for students. Here students can refer technical and advanced information for seminars and projects. Library holds books and journals related to different areas of Mechanical Engineering. The B.Tech Project / seminar reports of Mechanical Engineering students form a part of the Department Library.

  
PRINCIPAL  
Sri Indu Institute of Engineering & Tech.  
Sheriguda(V), Ibrahimpatnam(M),  
R.R. Dist. Telangana -501 510



### Class Rooms

Sl. No	Room No	Block & Floor	Area in Sq.M	Purpose	Teaching aids available like LCD/ Wifi/LAN Facilities
1	B-304	B Block& Third Floor	83.6 Sq,m	II-B YEAR CLASS ROOM	LCD,Projector/ wifi
2	B-303	B Block& Third Floor	83.6 Sq,m	III-A CLASS ROOM	LCD,Projector/ wifi
3	C-301	C Block& Third Floor	83.6 Sq,m	IV-B CLASS ROOM	WIFI
4	C-302	C Block& Third Floor	83.6 Sq,m	IV-A CLASS ROOM	LCD,Projector/ wifi
5	C-303	C Block& Third Floor	83.6 Sq,m	TUTORIAL ROOM	LCD,Projector/ wifi
6	C-306	C Block& Third Floor	83.6 Sq,m	TUTORIAL ROOM	WIFI

### Laboratory Rooms

Sl. No	Room No	Block & Floor	Area in Sq.M	Purpose	Teaching aids available like LCD/ Wifi/LAN Facilities
1	B-001	B Block & Ground Floor	75.4 Sq.m	PT LAB	WIFI/LAN
2	B-004	B Block & Ground Floor	73 Sq.m	ICS LAB	WIFI/LAN
3	B-005	B Block & Ground Floor	82.3 Sq.m	TE LAB	WIFI/ LAN
4	B-006	B Block & Ground Floor	114.5 Sq.m	FMHM LAB	WIFI/LAN
5	S-001	Shed & Ground Floor	111.3 Sq.m	MT LAB	WIFI/LAN
6	S-002	Shed & Ground Floor	73 Sq.m	WORK SHOP-1	WIFI/ LAN
7	S-003	Shed & Ground Floor	141.6 Sq.m	WORK SHOP-2	WIFI/LAN
8	S-004	Shed & Ground Floor	31.2 Sq.m	MMS LAB	WIFI/LAN
9	S-004	Shed & Ground Floor	31.2 Sq.m	MOS LAB	WIFI/ LAN
10	S-005	Shed & Ground Floor	31.2 Sq.m	HT LAB	WIFI/ LAN
11	S-006	Shed & Ground Floor	31.2 Sq.m	K&D LAB	WIFI/ LAN
12	C-001	C Block& Ground Floor	71.3Sq.m	CAD&CAM /CNCLAB	WIFI/ LAN
13	S-006A	Shed & Ground Floor	31.2 Sq.m	R&D LAB	WIFI/ LAN

  
PRINCIPAL  
Sri Indu Institute of Engineering & Tech.  
Shamshadpur, Khammam District (N)  
501 102 Telangana - 501 102



## **Sri Indu Institute of Engineering & Technology**

Recognized Under 2(f) of UGC Act 1986  
Approved by AICTE, New Delhi  
Affiliated to JNTUH, Hyderabad.

### **Department of Computer Science and Engineering**

#### **Class Rooms:**

The Department of Computer Science and Engineering has 15 class rooms for teaching and learning that are equipped with ICT enabled facilities such as LCD projectors, smart-interactive board and Wi-Fi and 3 tutorial classes. One class room is equipped with smart interactive boards and multimedia facilities.

#### **Laboratories:**

The Department has 16 dedicated laboratories with the latest version of hardware and software. They have sufficient well qualified and experienced technical and supporting staff and adequate number of laboratory equipments. Students are allowed to carry out mini projects and major projects in the respective laboratories in different time slots.

#### **Seminar Hall:**

The Department has 1 seminar hall with 200 seating capacity and this hall is used for the purpose of conducting guest lectures and seminars.

#### **Internet and WI-FI:**

The Department has internet speed with 100Mbps internet leased line for connecting all departments and their laboratories to share the information at the finger tips.

#### **Library:**

Computer Science Department's library contains various text books and reference books to cater the needs of the faculty members and students. It also comprises of International and National Journals and Magazines. Various question banks, previous year question papers and project reports are also available for reference. There are 1120 volumes and 10 national and 5 international journals in the department of library

  
PRINCIPAL  
Sri Indu Institute of Engineering & Tech.  
Sheriguda(V), Ibrahimpetnam(M),  
R.R. Dist. Telangana -501 510



### CLASS ROOMS

Sl. No	Room No	Block & Floor	Area in Sq.M	Purpose	Teaching aids available like LCD/ Wifi/LAN Facilities
1	A-101	A Block & First floor	77 Sq.m	IV CSE(C) Class room	LCD,Projector/ wifi
2	A-301	A Block & Third floor	77 Sq.m	II CSE(A) Class room	LCD,Projector/ wifi
3	A-302	A Block & Third floor	77 Sq.m	II CSE(B) Class room	LCD,Projector/ wifi
4	A-213	A Block & Second floor	77 Sq.m	II CSE(C) Class room	LCD,Projector/ wifi
5	A-202	A Block & Second floor	77 Sq.m	III CSE(A) Class room	LCD,Projector/ wifi
6	A-201	A Block & Second floor	77 Sq.m	III CSE(B) Class room	LCD,Projector/ wifi
7	A-208	A Block & Second floor	77 Sq.m	III CSE(C) Class room	LCD,Projector/ wifi
8	A-108	A Block & First floor	77 Sq.m	IV CSE(A) Class room	LCD,Projector/ wifi
9	A-109	A Block & First floor	77 Sq.m	IVCSE(B) Class room	LCD,Projector/ wifi
10	A-212	A Block & Second floor	77 Sq.m	CSE - TUTORIAL ROOM	WIFI
11	A-307	A Block & Third floor	77 Sq.m	CSE - TUTORIAL ROOM	WIFI
12	A-308	A Block & Third floor	77 Sq.m	CSE - TUTORIAL ROOM	WIFI
13	A-310	A Block & Third floor	77 Sq.m	II AIML – CLASS ROOM	WIFI
14	A-308	A Block & Third floor	77 Sq.m	II CS – CLASS ROOM	WIFI
15	A-308	A Block & Third floor	77 Sq.m	II IOT – CLASS ROOM	WIFI



## Laboratory Rooms

Sl. No	Room No	Block & Floor	Area in Sq.M	Purpose	Teaching aids available like LCD/ Wifi/LAN Facilities
1.	A-014	A Block & ground floor	77 Sq.m	PP/OS/ML LAB	WIFI/LAN
2.	A-015	A Block& ground floor	77 Sq.m	PPS LAB	WIFI/ LAN
3.	A-102	A Block& First floor	77 Sq.m	PP/OS LAB	WIFI/LAN
4.	A-105	A Block& First floor	77 Sq.m	DSTC++/ CD/SL LAB	WIFI/LAN
5.	A-106	A Block& First floor	150 Sq.m	PP/ML LAB	WIFI/ LAN
6.	A-107	A Block& First floor	77 Sq.m	DS/CD LAB	WIFI/LAN
7.	A-205	A Block& Second floor	77 Sq.m	DBMS/DM LAB	WIFI/LAN
8.	A-206	A Block& Second floor	77 Sq.m	CN /WT LAB	WIFI/ LAN
9.	A-207	A Block& Second floor	77 Sq.m	DS/CD LAB	WIFI/LAN
10.	D-005	D Block& Ground Floor	77 Sq.m	ITWS LAB	WIFI/LAN
11.	D-006	D Block& Ground Floor	77 Sq.m	SE/JAVA LAB	WIFI/ LAN
12.	D-007	D Block& Ground Floor	77 Sq.m	PPS LAB	WIFI/ LAN
13.	D-112	D Block& First Floor	77 Sq.m	CN AND WT/STM LAB	WIFI/LAN
14.	D-113	D Block& First Floor	77 Sq.m	DS/JAVA LAB	WIFI/LAN
15.	D-114	D Block& First Floor	77 Sq.m	SE/ DBMS LAB	WIFI/ LAN
16.	D-115	D Block& First Floor	77 Sq.m	DM/STM LAB	WIFI/LAN



## **Sri Indu Institute of Engineering & Technology**

Recognized Under 2(f) of UGC Act 1956

Approved by AICTE, New Delhi

Affiliated to JNTUH, Hyderabad.

### **Department of Civil Engineering**

#### **Class Rooms:**

The Civil department has 6 class rooms for teaching and learning in which 4 class rooms are equipped with ICT enabled facilities such as LCD projectors, smart interactive board and Wi-Fi . Smart Class Room: one class room is equipped with smart interactive boards and multimedia facilities.

#### **Laboratories:**

The department is equipped with modern equipment and highly 9 advanced laboratories. Department of Civil Engineering is spearheaded by highly competent, dedicated, well qualified and experienced faculty. The department laboratories are providing avenues for the students to qualify themselves as a good Civil Engineers and provide contribution to the development.

#### **Seminar Hall:**

The Department has one seminar hall and it is used for the purpose of conducting guest lectures, seminars, departmental activities and other co-curricular activities. It is fully air-conditioned and is suitable for international conferences, symposium, meetings, seminars, concerts, presentations and performances. The hall is fully equipped with state-of-the-art audio-visual devices providing services such as video conferencing, a sound system and audio-visual material.

#### **Internet and WI-FI:**

The institution apart from the computer laboratories setup for the syllabus programs has provided computer centers for general purposes. Learning is completely enabled with Wi-Fi facility and the institution has upgraded its internet speed to 100 Mbps through leased line.

#### **Library:**

The Department of Civil Engineering is well furnished with separate reading room and various technical sections as per AICTE norms. A well equipped, fully computerized and automated library with more technical and reference books and subscribes for national and international journals. It is also a subscriber of various magazines and news papers to cater the needs of students and teaching staff and keeps them update well informed. Various question banks, previous year question papers and project reports are also available for reference.

  
PRINCIPAL  
Sri Indu Institute of Engineering & Tech.  
Bhenguda(V), Ibrahimpatnam(M),  
R.R. Dist. Telangana -501 510





## Sri Indu Institute of Engineering & Technology

Recognized Under 2(f) of UGC Act 1956  
Approved by AICTE, New Delhi  
Affiliated to JNTUH, Hyderabad.

### Class Rooms

Sl. No	Room No	Block & Floor	Area in Sq.M	Purpose	Teaching aids available like LCD/ Wifi/LAN Facilities
1	D-314	D Block & Third Floor	73.71 Sqm	II Civil (A) Classroom	LCD,Projector/ wifi
2	D-313	D Block & Third Floor	73.71 Sqm	II Civil (B) Classroom	WIFI
3	D-312	D Block & Third Floor	73.71 Sqm	III Civil (A) Classroom	LCD,Projector/ wifi
4	D-308	D Block & Third Floor	73.71 Sqm	III Civil (B) Classroom	LCD,Projector/ wifi
5	D-307	D Block & Third Floor	50.44 Sqm	IV Civil (A) Classroom	LCD,Projector/ wifi
6	D-306	D Block & Third Floor	73.71 Sqm	IV Civil (B) Classroom	WIFI

### Laboratory Rooms

Sl. No	Room No	Block & Floor	Area in Sq.M	Purpose	Teaching aids available like LCD/ Wifi/LAN Facilities
1	S-004	Shed & Ground Floor	140.65 Sqm	Strength of materials lab	WIFI/ LAN
2	D-016	D Block & Cellar Ground Floor	75.2 Sqm	Surveying lab 1, 2	WIFI/LAN
3	D-001	D Block & Ground Floor	141.81 Sqm	Concrete technology lab	WIFI/LAN
4	D-002	D Block & Ground Floor	51.188 Sqm	Transportation engineering lab	WIFI/ LAN
5	D-003	D Block & Ground Floor	138.475 Sqm	Soil mechanics lab	WIFI/ LAN
6	B-001	B Block & Ground Floor	106.875 Sqm	Fluid mechanics and hydraulic machinery lab	WIFI/ LAN
7	D-112	D Block & First Floor	70.2 Sqm	Autocadd lab – 1, 2	WIFI/ LAN
8	D-302	D Block & Third Floor	74.1 Sqm	Engineering geology lab	WIFI/ LAN
9	D-308	D Block & Third Floor	117.4 Sqm	Environmental engineering lab	WIFI/ LAN

PRINCIPAL  
Sri Indu Institute of Engineering & Tech.  
Shankarapuram, Hyderabad-501 510  
S.R. Das, Telangana-501 510





## **Sri Indu Institute of Engineering & Technology**

Recognized Under 2(f) of UGC Act 1956

Approved by AICTE, New Delhi  
Affiliated to JNTUH, Hyderabad.

### **Department of Electronics and Communication Engineering**

#### **Class Rooms:**

The Department of Electronics and Communication Engineering has 9 class rooms for teaching and learning. 9 class rooms are equipped with ICT enabled facilities such as LCD projectors, smart interactive board and Wi-Fi. Smart Class One class room is equipped with smart interactive boards, multimedia facilities and one tutorial class room is available.

#### **Laboratories:**

There are 11 Laboratories in the department and the laboratories are equipped with adequate number of laboratory equipment. Students are allowed to carry out mini projects and major projects in the respective laboratories in different time slots.

#### **Seminar Hall:**

The Department has 1 seminar hall and this hall is used for the purpose of conducting guest lectures, seminars and other departmental activities.

#### **Internet and WI-FI:**

The institution is completely enabled with Wi-Fi facility and the institution has upgraded its internet speed to 100 Mbps through leased line.

#### **Library:**

The Department of Electronics and Communication Engineering library contains various text and reference book to cater the needs of our faculty members and students. It also comprises of International and National Journals and Magazines. Various question banks, previous year question papers and project reports are also available for reference. There are 148 books, 529 volumes and 19 national and 18 international journals in the department's library.

  
PRINCIPAL  
Sri Indu Institute of Engineering & Tech.  
Shenguda(V), Ibrahimpatnam(M),  
R.R. Dist. Telangana -501 510



# Sri Indu Institute of Engineering & Technology

Recognized Under 2(f) of UGC Act 1956

Approved by AICTE, New Delhi

Affiliated to JNTU/H, Hyderabad.

## Class Rooms

Sl. No	Room No	Block & Floor	Area in Sq.M	Purpose	Teaching aids available like LCD/ Wifi /LAN Facilities
1	B-101	B Block & First Floor	77 Sq.m	II ECE(A) classroom	LCD,Projector/ wifi
2	C-101	C Block & First Floor	77 Sq.m	II ECE(B) classroom	LCD,Projector/ wifi
3	C-102	C Block & First Floor	77 Sq.m	II ECE (C) classroom	LCD,Projector/ wifi
4	B-203	B Block & Second Floor	77 Sq.m	IV ECE (C) classroom	LCD,Projector/ wifi
5	B-202	B Block & Second Floor	77 Sq.m	IV ECE(B) classroom	LCD,Projector/ wifi
6	B-205	B Block & Second Floor	77 Sq.m	IV ECE(A) classroom	LCD,Projector/ wifi
7	C-201	C Block & Second Floor	40 Sq.m	Tutorial classroom-II	wifi
8	C-204	C Block & second Floor	77 Sq.m	Tutorial classroom-II	/ wifi
9	C-202	C Block & Second Floor	77 Sq.m	III ECE(B) classroom	LCD,Projector/ wifi
10	C-203	C Block & Second Floor	77 Sq.m	III ECE(C) classroom	LCD,Projector/ wifi
11	C-103	C Block & first Floor	77 Sq.m	III ECE(A) classroom	LCD,Projector/ wifi

  
PRINCIPAL  
Sri Indu Institute of Engineering & Tech  
Shankarapuram, Kothagudem (M),  
S.R. Dist. Telangana - 507 610



# Sri Indu Institute of Engineering & Technology

Recognized Under 2(f) of UGC Act 1956

Approved by AICTE, New Delhi

Affiliated to JNTUH, Hyderabad.

## Laboratory Rooms

Sl. No	Room No	Block & Floor	Area in Sq.M	Purpose	Teaching aids available like LCD/ Wifi/LAN Facilities
1	C-002	C Block & Ground Floor	77 Sq.m	DSP, BS lab-II, VLSI & ECAD lab	WIFI/ LAN
2	A-113	A Block & First Floor	77 Sq.m	EDC lab-I,ECA & AE lab	WIFI/LAN
3	A-114	A Block & First Floor	77 Sq.m	EDC lab-II & DICA lab	WIFI/LAN
4	A-116	A Block & First Floor	77 Sq.m	MWE lab	WIFI/ LAN
5	A-117	A Block & First Floor	77 Sq.m	MPMC lab-I	WIFI/LAN
6	A-118	A Block & First Floor	77 Sq.m	BS lab-I	WIFI/LAN
7	A-119	A Block & First Floor	77 Sq.m	MPMC lab-II	WIFI/ LAN
8	B-306(A)	B Block & Third Floor	77 Sq.m	ICA lab & LICA lab	WIFI/LAN
9	B-306(B)	B Block & Third Floor	77 Sq.m	PDC lab	WIFI/LAN
10	A-313	A Block & Third Floor	77 Sq.m	DE, AC & DC lab-II, DSD & CO lab	WIFI/ LAN
11	A-314	A Block & Third Floor	77 Sq.m	AC & DC lab-I,DC lab	WIFI/ LAN

Principal  
Sri Indu Institute of Engineering & Tech.  
Sherguda(V), Barampattanam(M),  
R.R. Dist. Tirunelveli - 625 810



**Sri Indu Institute of  
Engineering & Technology**

Recognized Under 2(f) of UGC Act 1956  
Approved by AICTE, New Delhi  
Affiliated to JNTUH, Hyderabad.

## **Department of Humanities & Sciences**

### **Class Rooms:**

The Humanities and Sciences department has 10 class rooms for teaching and learning in which 4 class rooms are equipped with ICT enabled facilities such as LCD projectors, smart interactive board and Wi-Fi. Class room is equipped with smart interactive boards and multimedia facilities. This department is multi-disciplinary in nature with faculty belonging to different disciplines namely English, Mathematics, Physics, Chemistry and Environmental Studies. The Humanities and Sciences department plays a vital role in guiding the budding engineering graduates so that they have a smooth transition from 10+2 level to the study of engineering and technology.

### **Laboratories:**

There are 12 Laboratories in the department and the laboratories are equipped with adequate number of laboratory equipments. Students are allowed to carry out mini projects and major projects in the respective laboratories in different time slots.

### **Seminar Hall:**

The College provides one spacious seminar with a varied seating capacity of 150 to 200 people. Having captivating ambience and all technical facilities, seminar halls are used for various purposes like guest lectures, workshops, student meetings, staff meetings, placement drives, Faculty Development Programs etc.

### **Computing Equipments:**

The institution has adequate number of computers, laptops, printers, scanners, servers, CC cameras to facilitate computing and internet browsing and surveillance.

### **Internet and WI-FI:**

The institution is completely enabled with Wi-Fi facility and the institution has upgraded its internet speed to 100 Mbps through leased line

### **Library:**

H&S Department's library contains various text and reference book to cater the needs of our faculty members and students. It also comprises of International and National Journals and magazines, various question banks and previous year question papers.

  
PRINCIPAL  
Sri Indu Institute of Engineering & Tech.  
Sheriguda(V), Ibrahimpetnam(M),  
R.R. Dist. Telangana - 501 512



# Sri Indu Institute of Engineering & Technology

Recognized Under 2(f) of UGC Act 1956

Approved by AICTE, New Delhi

Affiliated to JNTUH, Hyderabad.

## Class Rooms

Sl. No	Room No	Block & Floor	Area in Sq.M	Purpose	Teaching aids available like LCD/ Wifi/LAN Facilities
1	D-107	D Block & First Floor	77Sq.m	I-CSE-A	LCD,Projector/ wifi
2	D-109	D Block & First Floor	77Sq.m	I-CSE-C	LCD,Projector/ wifi
3	D-208	D Block & Second Floor	77Sq.m	I-ECE-A	LCD,Projector/ wifi
4	D-209	D Block & Second Floor	77Sq.m	I-ECE-B	wifi
5	D-210	D Block & Second Floor	77Sq.m	II-AIDS	wifi
6	D-108	D Block & First Floor	77Sq.m	I-CSE-B	LCD,Projector/ wifi
7	D-104	D Block & First Floor	77Sq.m	I-CIVIL (A)	wifi
8	D-105	D Block & first Floor	77Sq.m	I-IOT (A)	wifi
9	D-110	D Block & First Floor	77Sq.m	I-AIML (A)	wifi
10	D-207	D Block & second Floor	77Sq.m	I-CS	wifi

PRINCIPAL  
Sri Indu Institute of Engineering & Tech.  
Gnenguda(V), Ibrahimpatnam(M),  
S.R. Dist. Telangana -501 510



# Sri Indu Institute of Engineering & Technology

Recognized Under 2(f) of UGC Act 1956  
Approved by AICTE, New Delhi  
Affiliated to JNTUH, Hyderabad.

## Laboratory Rooms

Sl. No	Room No	Block & Floor	Area in Sq.M	Purpose	Teaching aids available like LCD/ Wifi/LAN Facilities
1	A-018	A Block & Ground Floor	77Sq.m	AECS lab	WIFI/ LAN
2	A-019	A Block & Ground Floor	77Sq.m	AECS lab	WIFI/LAN
3	A-005	A Block & Ground Floor	220Sq.m	BEE LAB-1	WIFI/LAN
4	A-305	A Block & Third Floor	220Sq.m	Drawing Lab	WIFI/ LAN
5	B-201	B Block & Third Floor	117Sq.m	Physics lab	WIFI/ LAN
6	D-106	D Block & First Floor	90Sq.m	Physics lab	WIFI/ LAN
7	B-104	B Block & First Floor	170Sq.m	Chemistry lab	WIFI/ LAN
8	D-103	D Block & First Floor	90Sq.m	Chemistry lab	WIFI/ LAN
9	D-012	D Block & Ground Floor	77Sq.m	ELCS lab	WIFI/ LAN
10	D-011	D Block & Ground Floor	77Sq.m	ELCS lab	WIFI/ LAN
11	D-305	D Block & 3rd Floor	77Sq.m	Drawing hall	WIFI/ LAN
12	A-007	A Block & ground floor	220sq.m	BEE lab-2	WIFI/ LAN

  
PRINCIPAL  
Sri Indu Institute of Engineering & Tech.  
Ghenguda(V), Brahmapatnam(M),  
R.R. Dist. Telangana-501 610



# A Block – Building Plan

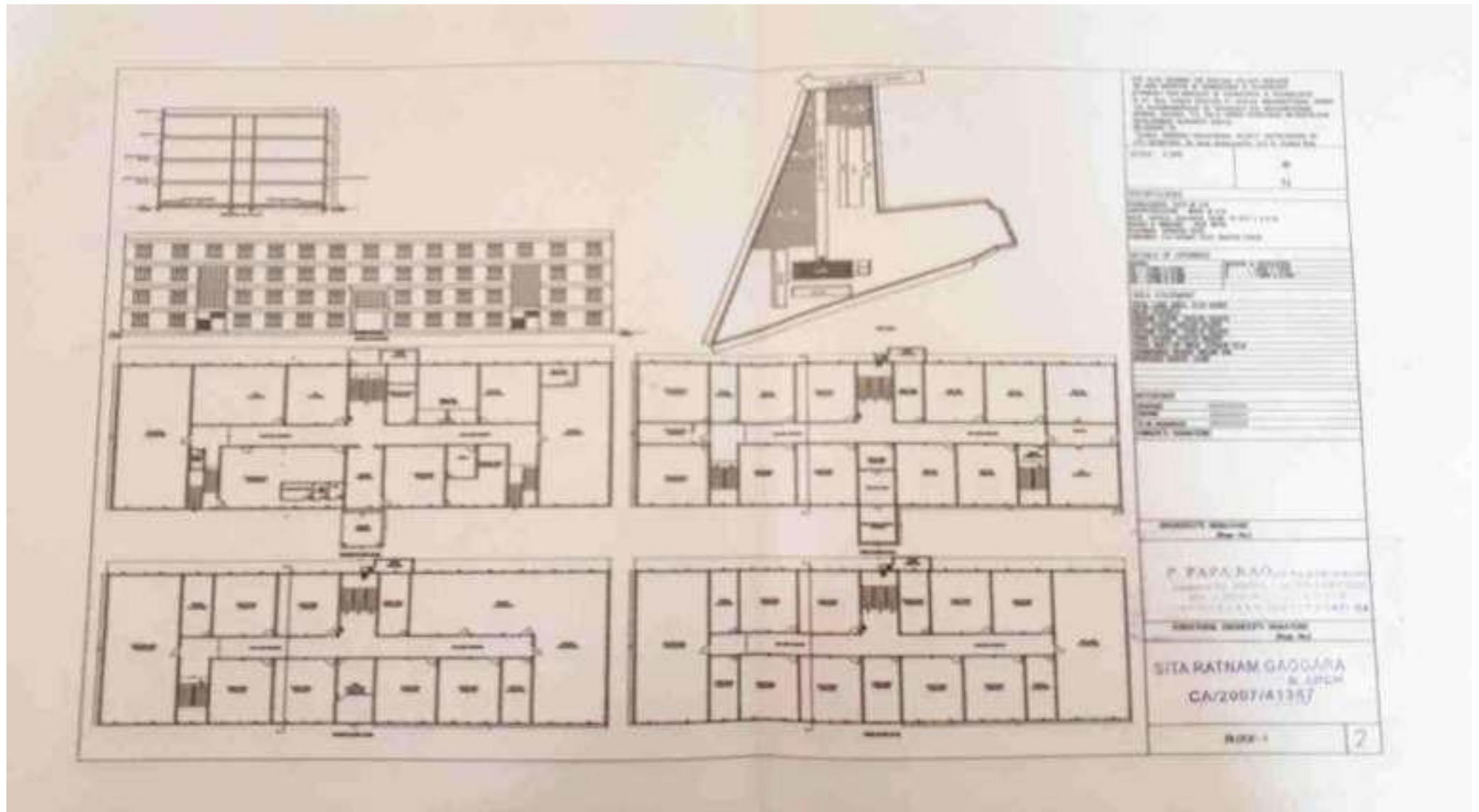

  
**PRINCIPAL**  
 Sri Indu Institute of Engineering & Tech.  
 (Sherguda(V), Bhubaneswar(M),  
 R.H. Dist. Telangana - 501 510)

[illegible]

**PRINCIPAL**  
SA Indu Institute of Engineering & Tech.  
Shengusa(V), Ibrahimpatnam(M),  
R.R. Dist. Telangana -501 310

The architectural drawings include:

- Top Left:** A long, narrow floor plan of a building with multiple rooms and a central corridor.
- Top Right:** A vertical section drawing showing the internal structure and roof profile.
- Middle Left:** A floor plan of a building with a central courtyard and surrounding rooms.
- Middle Right:** A floor plan of a building with a central courtyard and surrounding rooms.
- Bottom Left:** A floor plan of a building with a central courtyard and surrounding rooms.
- Bottom Right:** A floor plan of a building with a central courtyard and surrounding rooms.
- Far Right:** A large, irregularly shaped site plan or master plan showing the layout of the entire complex, including roads, parking areas, and building footprints.

The drawings are labeled with various dimensions and room numbers, indicating a detailed architectural design.

**PRINCIPAL**  
Sri Indu Institute of Engineering & Tech.  
Gheripada(V), Bheemapatnam(M),  
R.R. Dist. Telangana - 501 510



5068 h6. (14)

रु. 10

भारत

TEN  
RUPEES

**Rs. 10**

INDIA

# INDIA NON JUDICIAL

ఆంధ్రప్రదేశ్ ఆంధ్ర ప్రదేశ్ ANDHRA PRADESH

05AA 333667

5. ಮಂಜುಳಿ 5 ಕೆ 27222000

జి. వీరయ్య

శ్రీమద్భక్తవల్లభాచార్యుని పద్యములు

భూమి పుష్కరి

DIET SETTLEMENT DEPT

No. 3/88, Re. No. 10/2008,

(For Charitable Purpose)

ଉତ୍ତରୀୟ ଶିଳା, ଶିଳା, ଶିଳା, ଶିଳା

3 This Deed of Gift Settlement is made and executed on this 29<sup>th</sup> day of March 2006 at Ibrahimpatan, by:

**‘NEW LOYOLA MODEL EDUCATION SOCIETY’ Red.No:851/79 at Vanasthalipuram, Rep by It's Secretary & Correspondent Mr.R.VENKAT RAO S/o R.MALLA-RAO, Aged: 54 yrs, R/o Vanasthalipuram, R.R.Dist....**

¶ (Hereinafter called the **Donor/Settler** which term shall mean and include all it's heirs, Successors, administrators, assigns etc of One Part)

*IN FAVOUR OF*

**"GLOBAL TRENDSET EDUCATIONAL SOCIETY' Red.No:122/2006 at Vanasthalipuram, Rep by It's General Secretary Mr.ANUP CHAKRAVARTHY S/o R.VENKAT RAO, Aged:25 yrs, R/o Vanasthalipuram, R.R.Dist....**

(Hereinafter called the **Donee/Settlee** which term shall mean and include all it's Present and future Trustees, Successors-in-interest, administrators, assigns etc of the Other Part)

**Contd:2**

*[Signature]*

RV

1168/e

11.14



# Master Plan of the Campus

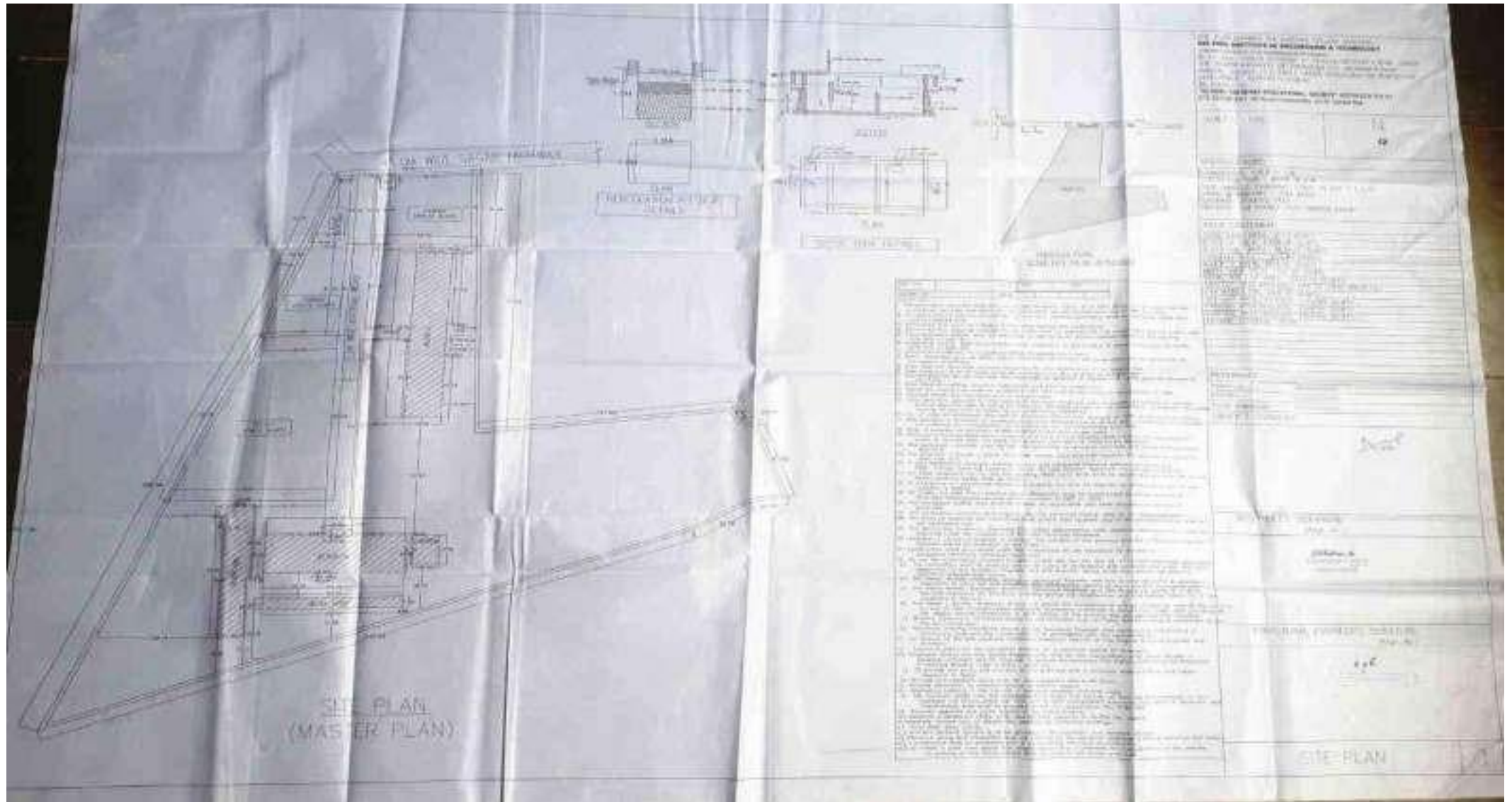

  
**PRINCIPAL**  
 Sri Indu Institute of Engineering & Tech.  
 Sherguda(V), Ibrahimpatnam(M),  
 R.R. Dist. Telangana -501 510



# Sri Indu Institute of Engineering & Technology

Recognized Under 2(f) of UGC Act 1956  
Approved by AICTE, New Delhi  
Affiliated to JNTUH, Hyderabad.

## DEPARTMENT OF MECHONICAL ENGINEERING LABORATORY&WORK SHOP PHOTOS

### CAD-CAM



  
PRINCIPAL  
Sri Indu Institute of Engineering & Tech.  
Sangareddy(V), Ibrahimpatnam(M),  
R.R. Dist. Telangana - 501 510





# Sri Indu Institute of Engineering & Technology

Recognized Under 2(f) of UGC Act 1956  
Approved by AICTE, New Delhi  
Affiliated to JNTUH, Hyderabad.

## ENGINEERING WORK SHOP PHOTOS



  
PRINCIPAL  
Sri Indu Institute of Engineering & Tech.  
Shergualla(V), Ibrahimpatnam(M),  
R.R. Dist. Telangana -501 510



# Sri Indu Institute of Engineering & Technology

Recognized Under 2(f) of UGC Act 1956  
Approved by AICTE, New Delhi  
Affiliated to JNTUH, Hyderabad.



## FLUID MECHANICS AND HYDRAULIC MACHINES LAB

### FM & FM WORK SHOP PHOTOS



  
PRINCIPAL  
Sri Indu Institute of Engineering & Tech.  
Gharguda(V), Ibrahimpatnam(M),  
R.R. Dist. Telangana -501 510





# Sri Indu Institute of Engineering & Technology

Recognized Under 2(f) of UGC Act 1956  
Approved by AICTE, New Delhi  
Affiliated to JNTU/H, Hyderabad.

FM & FM



FM & FM



  
PRINCIPAL  
Sri Indu Institute of Engineering & Tech.  
Bhongir(V), Ibrahimpatnam(M),  
R.R. Dist. Telangana -501 510



# Sri Indu Institute of Engineering & Technology

Recognized Under 2(f) of UGC Act 1956  
Approved by AICTE, New Delhi  
Affiliated to JNTU/H, Hyderabad.

## HEAT TRANSFER LAB



  
PRINCIPAL  
Sri Indu Institute of Engineering & Tech.  
Sherguda(V), Ibrahimpatnam(M),  
R.R. Dist. Telangana - 501 510





# Sri Indu Institute of Engineering & Technology

Recognized Under 2(f) of UGC Act 1956  
Approved by AICTE, New Delhi  
Affiliated to JNTU/H, Hyderabad.



## INSTRUMENTATION AND CONTROL SYSTEMS LAB PHOTOS



  
PRINCIPAL  
Sri Indu Institute of Engineering & Tech.  
Ghongula(V), Ibrahimpatnam(M),  
R.R. Dist. Telangana -501 510



# Sri Indu Institute of Engineering & Technology

Recognized Under 2(f) of UGC Act 1956  
Approved by AICTE, New Delhi  
Affiliated to JNTU/H, Hyderabad.



  
PRINCIPAL  
Sri Indu Institute of Engineering & Tech.  
Gharguda(V), Brahmampatnam(M),  
R.R. Dist. Telangana -501 510





# Sri Indu Institute of Engineering & Technology

Recognized Under 2(f) of UGC Act 1956  
Approved by AICTE, New Delhi  
Affiliated to JNTU/H, Hyderabad.

## KINEMATICS & DYNAMICS LAB PHOTOS

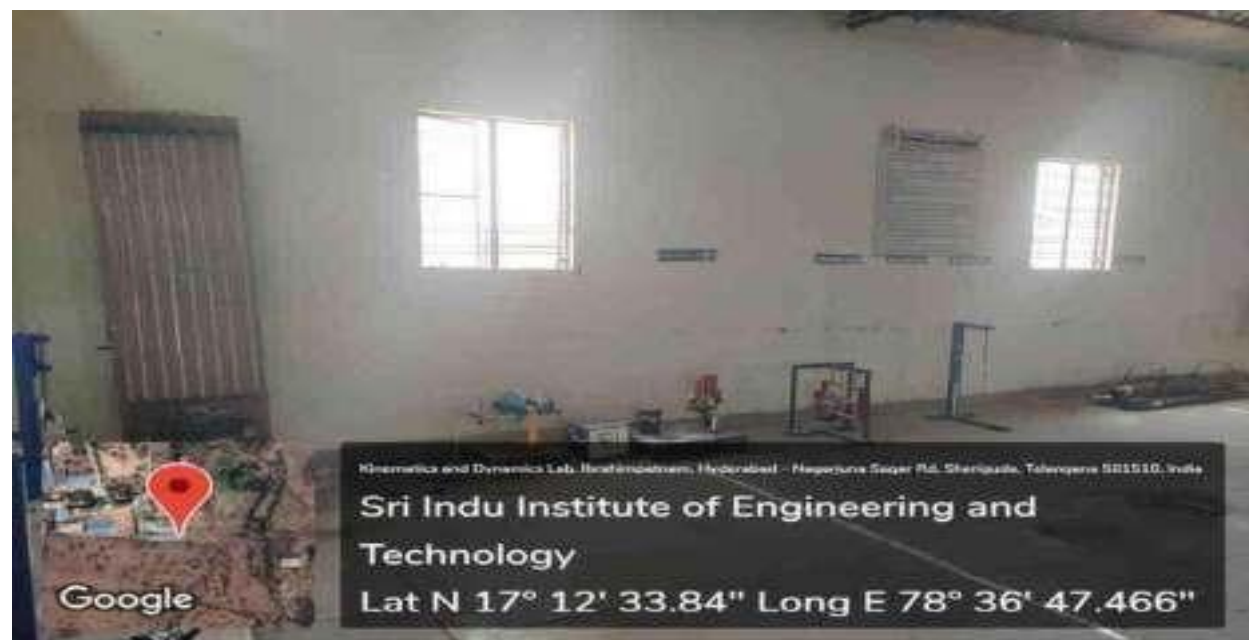

  
PRINCIPAL  
Sri Indu Institute of Engineering & Tech.  
Sherguda(V), Ibrahimpatnam(M),  
R.R. Dist. Telangana -501 510



# Sri Indu Institute of Engineering & Technology

Recognized Under 2(f) of UGC Act 1956  
Approved by AICTE, New Delhi  
Affiliated to JNTU/H, Hyderabad.

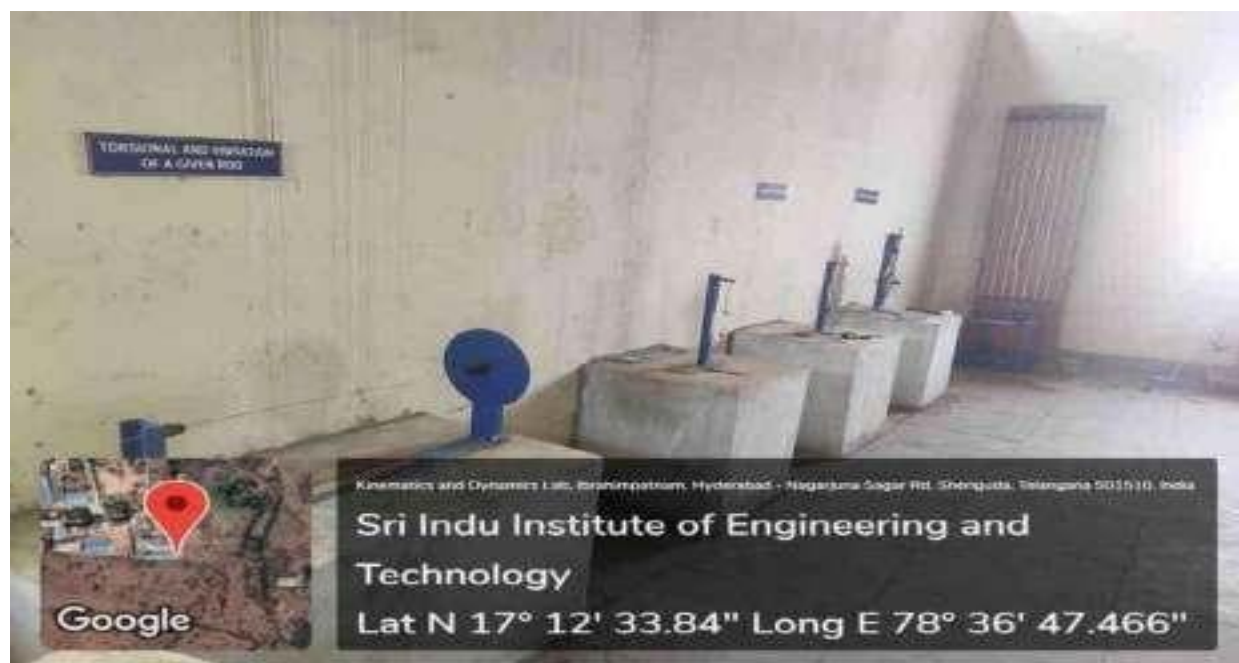

  
PRINCIPAL  
Sri Indu Institute of Engineering & Tech,  
Sherguda(V), Ibrahimpatnam(M),  
R.R. Dist. Telangana -501 510



# Sri Indu Institute of Engineering & Technology

Recognized Under 2(f) of UGC Act 1956  
Approved by AICTE, New Delhi  
Affiliated to JNTUH, Hyderabad.

## MACHINE DRAWING PRACTICE



PRINCIPAL  
Sri Indu Institute of Engineering & Tech.  
Shenguda(V), Ibrahimpatnam(M),  
R.R. Dist. Telangana -501 510





# Sri Indu Institute of Engineering & Technology

Recognized Under 2(f) of UGC Act 1956  
Approved by AICTE, New Delhi  
Affiliated to JNTUH, Hyderabad.



## MATERIAL SCIENCE AND MECHANICS OF SOLIDS LAB



PRINCIPAL  
Sri Indu Institute of Engineering & Tech.  
Shirguda(V), Ibrahimpatnam(M),  
R.R. Dist. Telangana - 501 510



# Sri Indu Institute of Engineering & Technology

Recognized Under 2(f) of UGC Act 1956  
Approved by AICTE, New Delhi  
Affiliated to JNTUH, Hyderabad.



PRINCIPAL  
Sri Indu Institute of Engineering & Tech,  
Sherguda(V), Ibrahimpatnam(M),  
R.R. Dist. Telangana - 501 510





# Sri Indu Institute of Engineering & Technology

Recognized Under 2(f) of UGC Act 1956  
Approved by AICTE, New Delhi  
Affiliated to JNTUH, Hyderabad.

## METROLOGY & MACHINE TOOLS LAB



  
PRINCIPAL  
Sri Indu Institute of Engineering & Tech.  
Sherguda(V), Ibrahimpatnam(M),  
R.R. Dist. Telangana - 501 510





# Sri Indu Institute of Engineering & Technology

Recognized Under 2(f) of UGC Act 1956  
Approved by AICTE, New Delhi  
Affiliated to JNTUH, Hyderabad.



Machine Tools & Metrology Lab, Ibrahimpatnam, Hyderabad - Nagarjuna Sagar Rd, Sherguda, Telangana 501510, India.

Sri Indu Institute of Engineering and Technology  
Lat N 17° 12' 33.7176" Long E 78° 36' 45.7092"

## PRODUCTION TECHNOLOGY LAB



Production Technology Lab, Ibrahimpatnam, Hyderabad - Nagarjuna Sagar Rd, Sherguda, Telangana 501510, India.

Sri Indu Institute of Engineering and Technology  
Lat N 17° 12' 35.0496" Long E 78° 36' 45.2628"

PRINCIPAL  
Sri Indu Institute of Engineering & Tech.  
Sherguda(V), Ibrahimpatnam(M),  
R.R. Dist. Telangana -501 510



# Sri Indu Institute of Engineering & Technology

Recognized Under 2(f) of UGC Act 1956  
Approved by AICTE, New Delhi  
Affiliated to JNTUH, Hyderabad.



  
PRINCIPAL  
Sri Indu Institute of Engineering & Tech.  
Sherguda(V), Ibrahimpatnam(M),  
R.R. Dist. Telangana - 501 510





# Sri Indu Institute of Engineering & Technology

Recognized Under 2(f) of UGC Act 1956  
Approved by AICTE, New Delhi  
Affiliated to JNTUH, Hyderabad.

## THERMAL ENGINEERING LAB



  
PRINCIPAL  
Sri Indu Institute of Engineering & Tech.  
Sherguda(V), Ibrahimpatnam(M),  
R.R. Dist. Telangana -501 510



# Sri Indu Institute of Engineering & Technology

Recognized Under 2(f) of UGC Act 1956  
Approved by AICTE, New Delhi  
Affiliated to JNTUH, Hyderabad.



## DEPARTMENT OF CIVIL ENGINEERING LABORATORY PHOTOS



  
PRINCIPAL  
Sri Indu Institute of Engineering & Tech.  
Sherguda(V), Ibrahimpatnam(M),  
R.R. Dist. Telangana - 501 510





# Sri Indu Institute of Engineering & Technology

Recognized Under 2(f) of UGC Act 1956  
Approved by AICTE, New Delhi  
Affiliated to JNTUH, Hyderabad.



  
PRINCIPAL  
Sri Indu Institute of Engineering & Tech.  
Sheriguda(V), Ibrahimpatnam(M),  
R.R. Dist. Telangana - 501 510



## Sri Indu Institute of Engineering & Technology

Recognized Under 2(f) of UGC Act 1956  
Approved by AICTE, New Delhi  
Affiliated to JNTUH, Hyderabad.



  
PRINCIPAL  
Sri Indu Institute of Engineering & Tech.  
Sheriguda(V), Ibrahimpatnam(M),  
R.R. Dist. Telangana -501 510



# Sri Indu Institute of Engineering & Technology

Recognized Under 2(f) of UGC Act 1956  
Approved by AICTE, New Delhi  
Affiliated to JNTUH, Hyderabad.

## DEPARTMENT OF CIVIL ENGINEERING CLASS ROOM PHOTOS

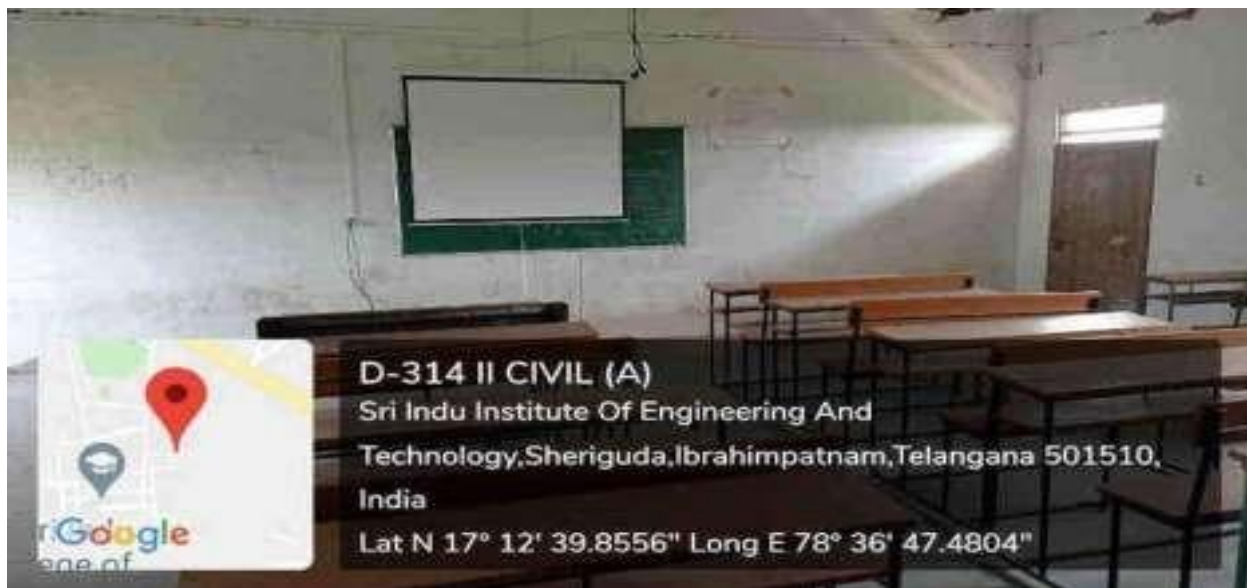

  
PRINCIPAL  
Sri Indu Institute of Engineering & Tech.  
Sheriguda(V), Ibrahimpatnam(M),  
R.R. Dist. Telangana - 501 510





# Sri Indu Institute of Engineering & Technology

Recognized Under 2(f) of UGC Act 1956  
Approved by AICTE, New Delhi  
Affiliated to JNTUH, Hyderabad.



D-312 III CIVIL (A)  
Sri Indu Institute Of Engineering And  
Technology, Sheriguda, Ibrahimpatnam, Telangana  
501510, India  
Lat N 17° 12' 39.4848" Long E 78° 36' 47.52"



D-312 III CIVIL (A)  
Sri Indu Institute Of Engineering And  
Technology, Sheriguda, Ibrahimpatnam, Telangana 501510,  
India  
Lat N 17° 12' 39.402" Long E 78° 36' 47.43"

  
PRINCIPAL  
Sri Indu Institute of Engineering & Tech.  
Sheriguda(V), Ibrahimpatnam(M),  
R.R. Dist. Telangana -501 510



# Sri Indu Institute of Engineering & Technology

Recognized Under 2(f) of UGC Act 1956  
Approved by AICTE, New Delhi  
Affiliated to JNTUH, Hyderabad.



  
PRINCIPAL  
Sri Indu Institute of Engineering & Tech.  
Sheriguda(V), Ibrahimpatnam(M),  
R.R. Dist. Telangana - 501 510



# Sri Indu Institute of Engineering & Technology

Recognized Under 2(f) of UGC Act 1956  
Approved by AICTE, New Delhi  
Affiliated to JNTUH, Hyderabad.



**D-306 IV CIVIL (B)**  
Sri Indu Institute Of Engineering And  
Technology, Sheriguda, Ibrahimpatnam, Telangana  
501510, India  
Lat N 17° 12' 38.6568" Long E 78° 36' 42.79"



**D-308 III- CIVIL (B)**  
Sri Indu Institute Of Engineering And  
Technology, Sheriguda, Ibrahimpatnam, Telangana  
501510, India  
Lat N 17° 12' 38.3652" Long E 78° 36' 42.4444"

  
**PRINCIPAL**  
Sri Indu Institute of Engineering & Tech.  
Sheriguda(V), Ibrahimpatnam(M),  
R.R. Dist. Telangana - 501 510





# Sri Indu Institute of Engineering & Technology

Recognized Under 2(f) of UGC Act 1956  
Approved by AICTE, New Delhi  
Affiliated to JNTUH, Hyderabad.



**D-308 III CIVIL (B)**  
Sri Indu Institute Of Engineering And  
Technology, Sheriguda, Ibrahimpatnam, Telangana 501510,  
India  
Lat N 17° 12' 38.5344" Long E 78° 36' 47.0376"



**D-307 IV-CIVIL (A)**  
Sri Indu Institute Of Engineering And  
Technology, Sheriguda, Ibrahimpatnam, Telangana  
501510, India  
Lat N 17° 12' 38.502" Long E 78° 36' 47.5556"

  
**PRINCIPAL**  
Sri Indu Institute of Engineering & Tech.  
Sheriguda(V), Ibrahimpatnam(M),  
R.R. Dist. Telangana -501 510





## Sri Indu Institute of Engineering & Technology

Recognized Under 2(f) of UGC Act 1956  
Approved by AICTE, New Delhi  
Affiliated to JNTUH, Hyderabad.



D-307 IV CIVIL (A)

Sri Indu Institute Of Engineering And

Technology, Sheriguda, Ibrahimpatnam, Telangana 501510,

India

Lat N 17° 12' 38.5164" Long E 78° 36' 47.0736"

  
PRINCIPAL  
Sri Indu Institute of Engineering & Tech.  
Sheriguda(V), Ibrahimpatnam(M),  
R.R. Dist. Telangana - 501 510



# Sri Indu Institute of Engineering & Technology

Recognized Under 2(f) of UGC Act 1956  
Approved by AICTE, New Delhi  
Affiliated to JNTUH, Hyderabad.

## DEPARTMENT OF COMPUTER SCIENCE ENGINEERING CLASS ROOM PHOTOS



  
PRINCIPAL  
Sri Indu Institute of Engineering & Tech.  
Sheriguda(V), Ibrahimpatnam(M),  
R.R. Dist. Telangana -501 510



# Sri Indu Institute of Engineering & Technology

Recognized Under 2(f) of UGC Act 1956  
Approved by AICTE, New Delhi  
Affiliated to JNTUH, Hyderabad.



  
PRINCIPAL  
Sri Indu Institute of Engineering & Tech.  
Sheriguda(V), Ibrahimpatnam(M),  
R.R. Dist. Telangana -501 510.





# Sri Indu Institute of Engineering & Technology

Recognized Under 2(f) of UGC Act 1956  
Approved by AICTE, New Delhi  
Affiliated to JNTUH, Hyderabad.



## Sheriguda, Telangana, India

SRI INDU INSTITUTE OF ENGINEERING AND TECHNOLOGY, BLOCK-A  
CSE TUTORIAL ROOM, Ibrahimpatnam, Hyderabad - Nagarjuna Sagar Rd,  
Sheriguda, Telangana 501510, India  
Lat N 17° 12' 35.1072"  
Long E 78° 38' 46.612"  
07/04/21 01:57 PM



## Sheriguda, Telangana, India

SRI INDU INSTITUTE OF ENGINEERING AND TECHNOLOGY, BLOCK-A CSE TUTORIAL  
ROOM, Ibrahimpatnam, Hyderabad - Nagarjuna Sagar Rd, Sheriguda, Telangana 501510,  
India  
Lat N 17° 12' 35.1072"  
Long E 78° 38' 46.612"  
07/04/21 01:57 PM

  
PRINCIPAL  
Sri Indu Institute of Engineering & Tech.  
Sheriguda(V), Ibrahimpatnam(M),  
R.R. Dist. Telangana - 501 510



# Sri Indu Institute of Engineering & Technology

Recognized Under 2(f) of UGC Act 1956  
Approved by AICTE, New Delhi  
Affiliated to JNTUH, Hyderabad.



PRINCIPAL  
Sri Indu Institute of Engineering & Tech.  
Sheriguda(V), Ibrahimpetnam(M),  
R.R. Dist. Telangana -501 510



# Sri Indu Institute of Engineering & Technology

Recognized Under 2(f) of UGC Act 1956  
Approved by AICTE, New Delhi  
Affiliated to JNTUH, Hyderabad.



## DEPARTMENT OF COMPUTER SCIENCE ENGINEERING LABORATORY PHOTOS



  
PRINCIPAL  
Sri Indu Institute of Engineering & Tech.  
Sheriguda(V), Ibrahimpatnam(M),  
R.R. Dist. Telangana-501 510





# Sri Indu Institute of Engineering & Technology

Recognized Under 2(f) of UGC Act 1956  
Approved by AICTE, New Delhi  
Affiliated to JNTUH, Hyderabad.



## Sheriguda, Telangana, India

SRI INDU INSTITUTE OF ENGINEERING AND TECHNOLOGY, CNS LAB Ibrahimpatnam,  
Hyderabad - Nagarjuna Sagar Rd, Sheriguda, Telangana 501510, India  
Lat N 17° 12' 35.0784"  
Long E 78° 36' 46.512"  
31/03/21 02:47 PM



## Sheriguda, Telangana, India

SRI INDU INSTITUTE OF ENGINEERING AND TECHNOLOGY, OS LAB Ibrahimpatnam,  
Hyderabad - Nagarjuna Sagar Rd, Sheriguda, Telangana 501510, India  
Lat N 17° 12' 35.0784"  
Long E 78° 36' 46.512"  
31/03/21 03:04 PM

  
PRINCIPAL  
Sri Indu Institute of Engineering & Tech.  
Sheriguda(V), Ibrahimpatnam(M),  
R.R. Dist. Telangana - 501 510



# Sri Indu Institute of Engineering & Technology

Recognized Under 2(f) of UGC Act 1956  
Approved by AICTE, New Delhi  
Affiliated to JNTUH, Hyderabad.

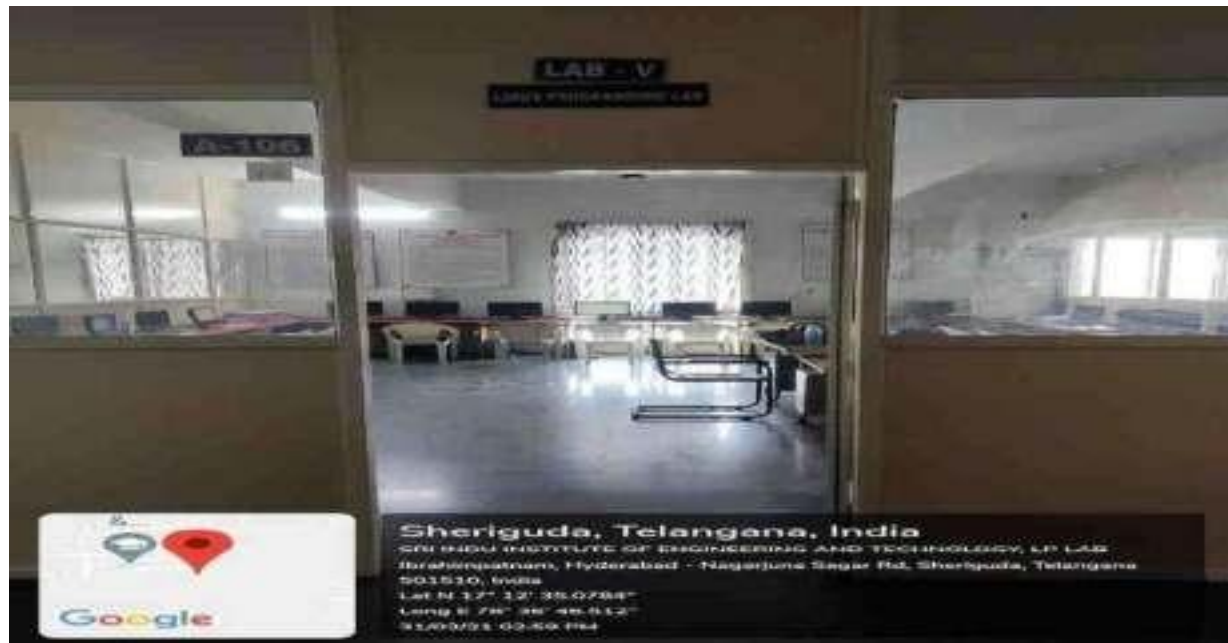

## Sheriguda, Telangana, India

SRI INDU INSTITUTE OF ENGINEERING AND TECHNOLOGY, LP LAB  
Ibrahimpatnam, Hyderabad - Nagarjuna Sagar Rd, Sheriguda, Telangana  
501510, India  
Lat N 17° 12' 35.0754"  
Long E 78° 36' 46.512"  
31/03/21 02:59 PM



## Sheriguda, Telangana, India

SRI INDU INSTITUTE OF ENGINEERING AND TECHNOLOGY, DBMS LAB  
Ibrahimpatnam, Hyderabad - Nagarjuna Sagar Rd, Sheriguda, Telangana  
501510, India  
Lat N 17° 12' 35.0754"  
Long E 78° 36' 46.512"  
31/03/21 02:40 PM

  
PRINCIPAL  
Sri Indu Institute of Engineering & Tech.  
Sheriguda(V), Ibrahimpatnam(M),  
R.R. Dist. Telangana - 501 510



# Sri Indu Institute of Engineering & Technology

Recognized Under 2(f) of UGC Act 1956  
Approved by AICTE, New Delhi  
Affiliated to JNTUH, Hyderabad.

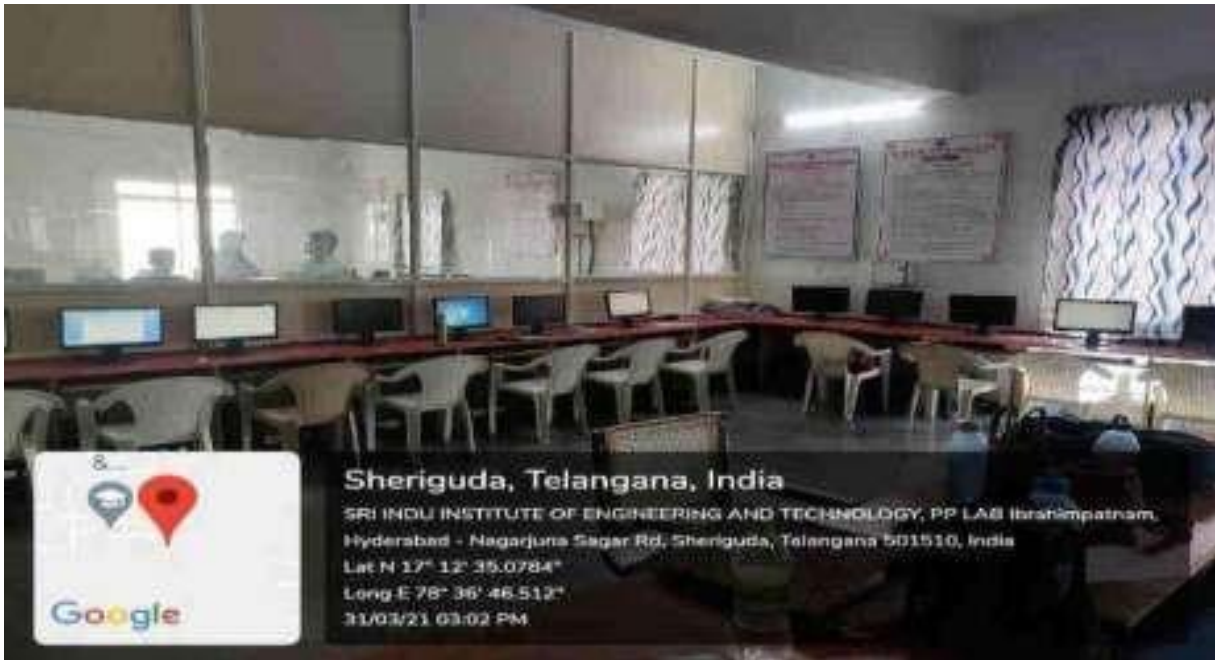

  
PRINCIPAL  
Sri Indu Institute of Engineering & Tech,  
Sheriguda(V), Ibrahimpatnam(M),  
R.R. Dist. Telangana - 501 510





# Sri Indu Institute of Engineering & Technology

Recognized Under 2(f) of UGC Act 1956  
Approved by AICTE, New Delhi  
Affiliated to JNTUH, Hyderabad.

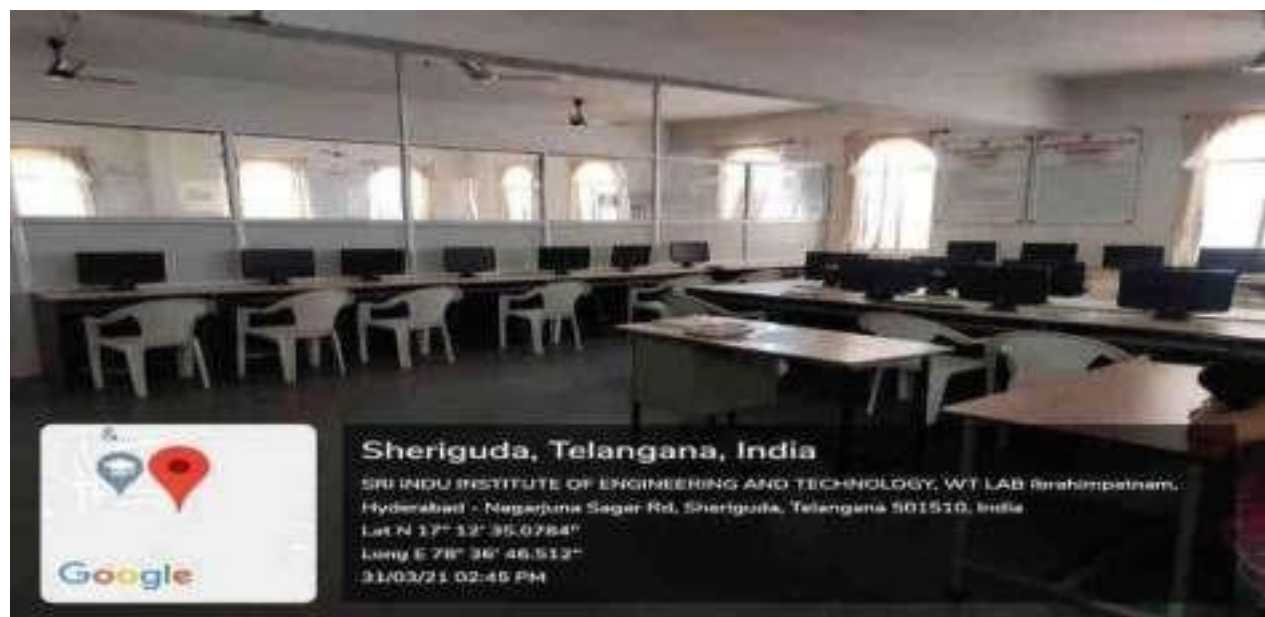

  
PRINCIPAL  
Sri Indu Institute of Engineering & Tech.  
Sheriguda(V), Ibrahimpatnam(M),  
R.R. Dist. Telangana -501 510



# Sri Indu Institute of Engineering & Technology

Recognized Under 2(f) of UGC Act 1956  
Approved by AICTE, New Delhi  
Affiliated to JNTUH, Hyderabad.



  
PRINCIPAL  
Sri Indu Institute of Engineering & Tech.  
Sheriguda(V), Ibrahimpetnam(M),  
R.R. Dist. Telangana -501 510





# Sri Indu Institute of Engineering & Technology

Recognized Under 2(f) of UGC Act 1956  
Approved by AICTE, New Delhi  
Affiliated to JNTUH, Hyderabad.



## Sheriguda, Telangana, India

SRI INDU INSTITUTE OF ENGINEERING AND TECHNOLOGY, DS LAB Ibrahimpatnam,  
Hyderabad - Nagarjuna Sagar Rd, Sheriguda, Telangana 501510, India  
Lat N 17° 12' 35.0784"  
Long E 78° 36' 46.512"  
31/03/21 02:20 PM

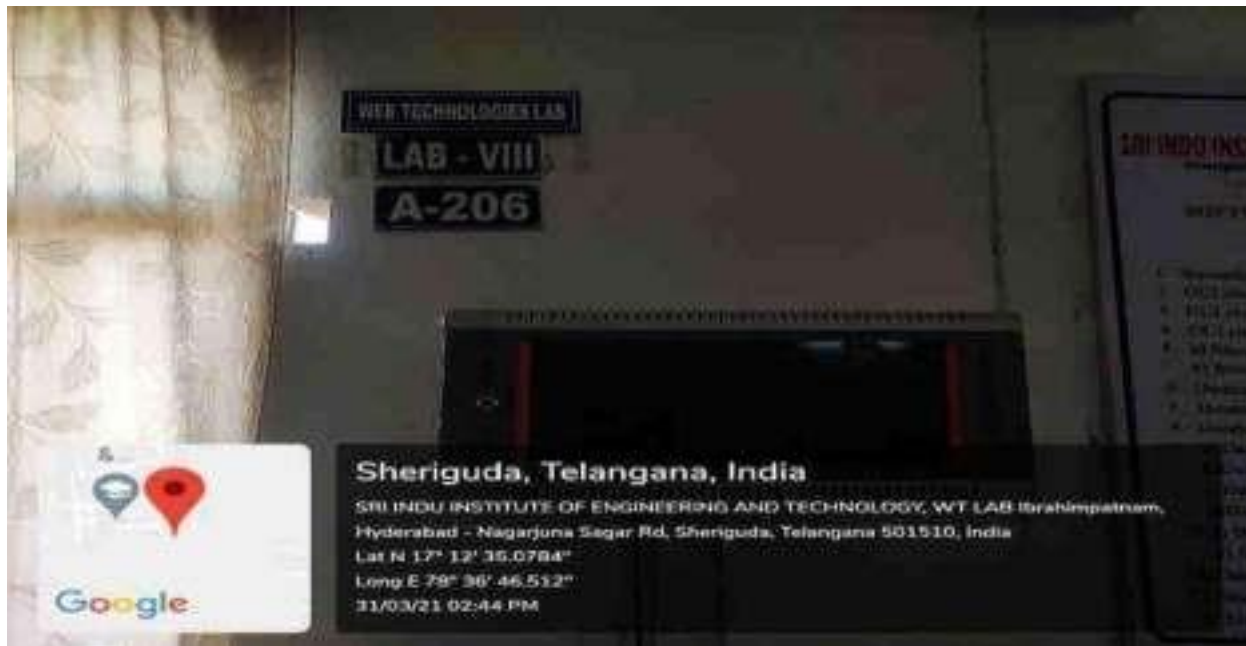

## Sheriguda, Telangana, India

SRI INDU INSTITUTE OF ENGINEERING AND TECHNOLOGY, WT LAB Ibrahimpatnam,  
Hyderabad - Nagarjuna Sagar Rd, Sheriguda, Telangana 501510, India  
Lat N 17° 12' 35.0784"  
Long E 78° 36' 46.512"  
31/03/21 02:44 PM

  
PRINCIPAL  
Sri Indu Institute of Engineering & Tech.  
Sheriguda(V), Ibrahimpatnam(M),  
R.R. Dist. Telangana -501 510





# Sri Indu Institute of Engineering & Technology

Recognized Under 2(f) of UGC Act 1956  
Approved by AICTE, New Delhi  
Affiliated to JNTUH, Hyderabad.



  
PRINCIPAL  
Sri Indu Institute of Engineering & Tech.  
Sheriguda(V), Ibrahimpatnam(M),  
R.R. Dist. Telangana -501 510



# Sri Indu Institute of Engineering & Technology

Recognized Under 2(f) of UGC Act 1956  
Approved by AICTE, New Delhi  
Affiliated to JNTUH, Hyderabad.



## Sheriguda, Telangana, India

SRI INDU INSTITUTE OF ENGINEERING AND TECHNOLOGY, DWDM LAB  
Ibrahimpetnam, Hyderabad - Nagarjuna Sagar Rd, Sheriguda, Telangana  
501510, India  
Lat N 17° 12' 35.0784"  
Long E 78° 36' 46.512"  
31/03/21 02:38 PM



## Sheriguda, Telangana, India

SRI INDU INSTITUTE OF ENGINEERING AND TECHNOLOGY, CNS LAB Ibrahimpetnam,  
Hyderabad - Nagarjuna Sagar Rd, Sheriguda, Telangana 501510, India  
Lat N 17° 12' 35.0784"  
Long E 78° 36' 46.512"  
31/03/21 02:47 PM

  
PRINCIPAL  
Sri Indu Institute of Engineering & Tech.  
Sheriguda(V), Ibrahimpetnam(M),  
R.R. Dist. Telangana -501 510





# Sri Indu Institute of Engineering & Technology

Recognized Under 2(f) of UGC Act 1956  
Approved by AICTE, New Delhi  
Affiliated to JNTUH, Hyderabad.



## Sheriguda, Telangana, India

SRI INDU INSTITUTE OF ENGINEERING AND TECHNOLOGY, OOPs through JAVA LAB  
Ibrahimpatnam, Hyderabad - Nagarjuna Sagar Rd, Sheriguda, Telangana 501510, India  
Lat N 17° 12' 35.0784"  
Long E 78° 36' 46.512"  
31/03/21 02:49 PM



## Sheriguda, Telangana, India

SRI INDU INSTITUTE OF ENGINEERING AND TECHNOLOGY, DBMS LAB Ibrahimpatnam,  
Hyderabad - Nagarjuna Sagar Rd, Sheriguda, Telangana 501510, India  
Lat N 17° 12' 35.0784"  
Long E 78° 36' 46.512"  
31/03/21 02:23 PM

  
PRINCIPAL  
Sri Indu Institute of Engineering & Tech.  
Sheriguda(V), Ibrahimpatnam(M),  
R.R. Dist. Telangana - 501 510





# Sri Indu Institute of Engineering & Technology

Recognized Under 2(f) of UGC Act 1956  
Approved by AICTE, New Delhi  
Affiliated to JNTUH, Hyderabad.



## Sheriguda, Telangana, India

SRI INDU INSTITUTE OF ENGINEERING AND TECHNOLOGY, OOPs through JAVA LAB  
Ibrahimpattanam, Hyderabad - Nagarjuna Sagar Rd, Sheriguda, Telangana 501510, India.  
Lat N 17° 12' 35.0784"  
Long E 78° 36' 46.512"  
31/03/21 02:49 PM



## Sheriguda, Telangana, India

SRI INDU INSTITUTE OF ENGINEERING AND TECHNOLOGY, OS LAB Ibrahimpattanam,  
Hyderabad - Nagarjuna Sagar Rd, Sheriguda, Telangana 501510, India.  
Lat N 17° 12' 35.0784"  
Long E 78° 36' 46.512"  
31/03/21 03:04 PM

  
PRINCIPAL  
Sri Indu Institute of Engineering & Tech.  
Sheriguda(V), Ibrahimpattanam(M),  
R.R. Dist. Telangana -501 510



# Sri Indu Institute of Engineering & Technology

Recognized Under 2(f) of UGC Act 1956  
Approved by AICTE, New Delhi  
Affiliated to JNTUH, Hyderabad.



  
**PRINCIPAL**  
Sri Indu Institute of Engineering & Tech.  
Sheriguda(V), Ibrahimpattam(M),  
R.R. Dist. Telangana -501 510





# Sri Indu Institute of Engineering & Technology

Recognized Under 2(f) of UGC Act 1956  
Approved by AICTE, New Delhi  
Affiliated to JNTUH, Hyderabad.



  
**PRINCIPAL**  
Sri Indu Institute of Engineering & Tech.  
Sheriguda(V), Ibrahimpattanam(M),  
R.R. Dist Telangana -501 510





# Sri Indu Institute of Engineering & Technology

Recognized Under 2(f) of UGC Act 1956  
Approved by AICTE, New Delhi  
Affiliated to JNTUH, Hyderabad.



  
PRINCIPAL  
Sri Indu Institute of Engineering & Tech.  
Sheriguda(V), Ibrahimpatnam(M),  
R.R. Dist. Telangana - 501 510



# Sri Indu Institute of Engineering & Technology

Recognized Under 2(f) of UGC Act 1956  
Approved by AICTE, New Delhi  
Affiliated to JNTUH, Hyderabad.



  
PRINCIPAL  
Sri Indu Institute of Engineering & Tech.  
Sheriguda(V), Ibrahimpatnam(M),  
R.R. Dist. Telangana -501 510



# Sri Indu Institute of Engineering & Technology

Recognized Under 2(f) of UGC Act 1956  
Approved by AICTE, New Delhi  
Affiliated to JNTUH, Hyderabad.



## Sheriguda, Telangana, India

SRI INDU INSTITUTE OF ENGINEERING AND TECHNOLOGY, DBMS LAB Ibrahimpatnam,  
Hyderabad - Nagarjuna Sagar Rd, Sheriguda, Telangana 501510, India  
Lat N 17° 12' 35.0784"  
Long E 78° 36' 46.512"  
31/03/21 02:23 PM



## Sheriguda, Telangana, India

SRI INDU INSTITUTE OF ENGINEERING AND TECHNOLOGY, DS LAB  
Ibrahimpatnam, Hyderabad - Nagarjuna Sagar Rd, Sheriguda, Telangana  
501510, India  
Lat N 17° 12' 35.0784"  
Long E 78° 36' 46.512"  
31/03/21 02:21 PM

  
**PRINCIPAL**  
Sri Indu Institute of Engineering & Tech.  
Sheriguda(V), Ibrahimpatnam(M),  
R.R. Dist. Telangana - 501 510





# Sri Indu Institute of Engineering & Technology

Recognized Under 2(f) of UGC Act 1956  
Approved by AICTE, New Delhi  
Affiliated to JNTUH, Hyderabad.



## Sheriguda, Telangana, India

SRI INDU INSTITUTE OF ENGINEERING AND TECHNOLOGY, CDS LAB  
Brahmapatnam, Hyderabad - Nagarjuna Sagar Rd, Sheriguda, Telangana  
501510, India  
Lat N 17° 12' 35.0764"  
Long E 78° 36' 46.512"  
31/03/21 02:45 PM



## Sheriguda, Telangana, India

SRI INDU INSTITUTE OF ENGINEERING AND TECHNOLOGY, PP LAB  
Brahmapatnam, Hyderabad - Nagarjuna Sagar Rd, Sheriguda, Telangana  
501510, India  
Lat N 17° 12' 35.0764"  
Long E 78° 36' 46.512"  
31/03/21 03:02 PM

  
PRINCIPAL  
Sri Indu Institute of Engineering & Tech.  
Sheriguda(V), Ibrahimpatnam(M),  
R.R. Dist. Telangana -501 510



# Sri Indu Institute of Engineering & Technology

Recognized Under 2(f) of UGC Act 1956  
Approved by AICTE, New Delhi  
Affiliated to JNTUH, Hyderabad.



  
**PRINCIPAL**  
Sri Indu Institute of Engineering & Tech.  
Sheriguda(V), Ibrahimpatnam(M),  
R.R. Dist. Telangana -501 510





# Sri Indu Institute of Engineering & Technology

Recognized Under 2(f) of UGC Act 1956  
Approved by AICTE, New Delhi  
Affiliated to JNTUH, Hyderabad.



## Sheriguda, Telangana, India

SRI INDU INSTITUTE OF ENGINEERING AND TECHNOLOGY, DBMS LAB Ibrahimpatnam,  
Hyderabad - Nagarjuna Sagar Rd, Sheriguda, Telangana 501510, India  
Lat N 17° 12' 35.0784"  
Long E 78° 36' 46.512"  
31/03/21 02:41 PM



## Sheriguda, Telangana, India

SRI INDU INSTITUTE OF ENGINEERING AND TECHNOLOGY, PP LAB Ibrahimpatnam,  
Hyderabad - Nagarjuna Sagar Rd, Sheriguda, Telangana 501510, India  
Lat N 17° 12' 35.0784"  
Long E 78° 36' 46.512"  
31/03/21 03:02 PM

  
**PRINCIPAL**  
Sri Indu Institute of Engineering & Tech.  
Sheriguda(V), Ibrahimpatnam(M),  
R.R. Dist. Telangana - 501 510





# Sri Indu Institute of Engineering & Technology

Recognized Under 2(f) of UGC Act 1956  
Approved by AICTE, New Delhi  
Affiliated to JNTUH, Hyderabad.

## DEPARTMENT OF ECE CLASS ROOM PHOTOS



  
PRINCIPAL  
Sri Indu Institute of Engineering & Tech.  
Sheriguda(V), Ibrahimpatnam(M),  
R.R. Dist. Telangana -501 510



# Sri Indu Institute of Engineering & Technology

Recognized Under 2(f) of UGC Act 1956  
Approved by AICTE, New Delhi  
Affiliated to JNTUH, Hyderabad.



B-205 IV-ECE A  
Sri Indu Institute of Engineering and Technology  
Sheriguda, Ibrahimpatnam, Hyderabad -  
Nagarjuna Sagar Rd, Telangana 501510, India  
Lat N 17° 12' 34.0488" Long E 78° 36' 45.288"

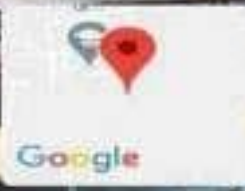

B-205 IV-ECE A  
Sri Indu Institute of Engineering and Technology Sheriguda,  
Ibrahimpatnam, Hyderabad - Nagarjuna Sagar Rd, Telangana  
501510, India  
Lat N 17° 12' 34.0308" Long E 78° 36' 45.4644"

  
PRINCIPAL  
Sri Indu Institute of Engineering & Tech.  
Sheriguda(V), Ibrahimpatnam(M),  
R.R. Dist. Telangana -501 510





# Sri Indu Institute of Engineering & Technology

Recognized Under 2(f) of UGC Act 1956  
Approved by AICTE, New Delhi  
Affiliated to JNTUH, Hyderabad.



  
**PRINCIPAL**  
Sri Indu Institute of Engineering & Tech.  
Sheriguda(V), Ibrahimpatnam(M),  
R.R. Dist Telangana - 501 510





# Sri Indu Institute of Engineering & Technology

Recognized Under 2(f) of UGC Act 1956  
Approved by AICTE, New Delhi  
Affiliated to JNTUH, Hyderabad.



**B-203 IV-ECE C**  
Sri Indu Institute of Engineering and Technology  
Sheriguda, Ibrahimpatnam, Hyderabad -  
Nagarjuna Sagar Rd, Telangana 501510, India  
Lat N 17° 12' 34.92" Long E 78° 36' 44.964"



**B-203 IV-ECE C**  
Sri Indu Institute of Engineering and Technology Sheriguda,  
Ibrahimpatnam, Hyderabad - Nagarjuna Sagar Rd, Telangana  
501510, India  
Lat N 17° 12' 34.8408" Long E 78° 36' 45.2088"

  
**PRINCIPAL**  
Sri Indu Institute of Engineering & Tech.  
Sheriguda(V), Ibrahimpatnam(M),  
R.R. Dist. Telangana -501 510



# Sri Indu Institute of Engineering & Technology

Recognized Under 2(f) of UGC Act 1956  
Approved by AICTE, New Delhi  
Affiliated to JNTUH, Hyderabad.



**C-203 III-ECE A**  
Sri Indu Institute of Engineering and Technology  
Sheriguda, Ibrahimpatnam, Hyderabad -  
Nagarjuna Sagar Rd, Telangana 501510, India  
Lat N 17° 12' 35.46" Long E 78° 36' 44.9856"



**C-203 III-ECE A**  
Sri Indu Institute of Engineering and Technology Sheriguda,  
Ibrahimpatnam, Hyderabad - Nagarjuna Sagar Rd, Telangana  
501510, India  
Lat N 17° 12' 35.0496" Long E 78° 36' 45.018"

  
PRINCIPAL  
Sri Indu Institute of Engineering & Tech.  
Sheriguda(V), Ibrahimpatnam(M),  
R.R. Dist. Telangana -501 510





# Sri Indu Institute of Engineering & Technology

Recognized Under 2(f) of UGC Act 1956  
Approved by AICTE, New Delhi  
Affiliated to JNTUH, Hyderabad.



**C-202 III-ECE B**  
Sri Indu Institute of Engineering and Technology  
Sheriguda, Ibrahimpatnam, Hyderabad -  
Nagarjuna Sagar Rd, Telangana 501510, India  
Lat N 17° 12' 35.0604" Long E 78° 36' 42.0732"



**C-202 III-ECE B**  
Sri Indu Institute of Engineering and Technology Sheriguda,  
Ibrahimpatnam, Hyderabad - Nagarjuna Sagar Rd, Telangana  
501510, India  
Lat N 17° 12' 35.496" Long E 78° 36' 45.0396"

  
**PRINCIPAL**  
Sri Indu Institute of Engineering & Tech.  
Sheriguda(V), Ibrahimpatnam(M),  
R.R. Dist Telangana -501 510





# Sri Indu Institute of Engineering & Technology

Recognized Under 2(f) of UGC Act 1956  
Approved by AICTE, New Delhi  
Affiliated to JNTUH, Hyderabad.



  
PRINCIPAL  
Sri Indu Institute of Engineering & Tech.  
Sheriguda(V), Ibrahimpatnam(M),  
R.R. Dist. Telangana -501 510



# Sri Indu Institute of Engineering & Technology

Recognized Under 2(f) of UGC Act 1956  
Approved by AICTE, New Delhi  
Affiliated to JNTUH, Hyderabad.



  
PRINCIPAL  
Sri Indu Institute of Engineering & Tech.  
Sheriguda(V), Ibrahimpatnam(M),  
R.R. Dist. Telangana -501 510





# Sri Indu Institute of Engineering & Technology

Recognized Under 2(f) of UGC Act 1956  
Approved by AICTE, New Delhi  
Affiliated to JNTUH, Hyderabad.



C-101 II-ECE B

Sri Indu Institute of Engineering and Technology Sheriguda,  
Ibrahimpattam, Hyderabad - Nagarjuna Sagar Rd, Telangana  
501510, India

Lat N 17° 12' 34.9596" Long E 78° 36' 45.1872"



C-101(II-ECE B)

Sri Indu Institute of Engineering and Technology  
Sheriguda, Ibrahimpattam, Hyderabad -  
Nagarjuna Sagar Rd, Telangana 501510, India

Lat N 17° 12' 35.1036" Long E 78° 36' 45.2806"

  
PRINCIPAL  
Sri Indu Institute of Engineering & Tech.  
Sheriguda(V), Ibrahimpattam(M),  
R.R. Dist. Telangana -501 510





# Sri Indu Institute of Engineering & Technology

Recognized Under 2(f) of UGC Act 1956  
Approved by AICTE, New Delhi  
Affiliated to JNTUH, Hyderabad.

## DEPARTMENT OF ECE LABORATORY PHOTOS



  
PRINCIPAL  
Sri Indu Institute of Engineering & Tech.  
Sheriguda(V), Ibrahimpatnam(M),  
R.R. Dist. Telangana -501 510



# Sri Indu Institute of Engineering & Technology

Recognized Under 2(f) of UGC Act 1956  
Approved by AICTE, New Delhi  
Affiliated to JNTUH, Hyderabad.



## Basic Simulation Lab

Sri Indu Institute of Engineering and Technology, Sheriguda,  
Ibrahimpattanam, Nagarjuna Sagar Rd, , Telangana 501510,  
India

Lat N 17° 12' 35.6184" Long E 78° 36' 45.0972"



## Digital System Design Lab

Sri Indu Institute of Engineering and Technology Sheriguda,  
Ibrahimpattanam, Hyderabad - Nagarjuna Sagar Rd, Telangana  
501510, India

Lat N 17° 12' 34.74" Long E 78° 36' 45.54"

  
PRINCIPAL  
Sri Indu Institute of Engineering & Tech.  
Sheriguda(V), Ibrahimpattanam(M),  
R.R. Dist. Telangana -501 510





# Sri Indu Institute of Engineering & Technology

Recognized Under 2(f) of UGC Act 1956  
Approved by AICTE, New Delhi  
Affiliated to JNTUH, Hyderabad.



PRINCIPAL  
Sri Indu Institute of Engineering & Tech.  
Sheriguda(V), Ibrahimpatnam(M),  
R.R. Dist. Telangana -501 510





# Sri Indu Institute of Engineering & Technology

Recognized Under 2(f) of UGC Act 1956  
Approved by AICTE, New Delhi  
Affiliated to JNTUH, Hyderabad.



  
PRINCIPAL  
Sri Indu Institute of Engineering & Tech.  
Sheriguda(V), Ibrahimpatnam(M),  
R.R. Dist. Telangana - 501 510



## Sri Indu Institute of Engineering & Technology

Recognized Under 2(f) of UGC Act 1986  
Approved by AICTE, New Delhi  
Affiliated to JNTUH, Hyderabad.



**Electronic Devices and Circuits Lab**  
Sri Indu Institute of Engineering and Technology Sheriguda,  
Ibrahimpattam, Hyderabad - Nagarjuna Sagar Rd, Telangana  
501510, India  
Lat N 17° 12' 34.992" Long E 78° 36' 46.4796"

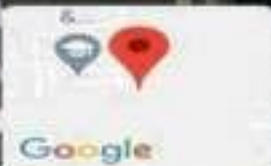

**Data Communications and Networks Lab**  
Sri Indu Institute of Engineering and Technology, Sheriguda,  
Ibrahimpattam, Nagarjuna Sagar Rd, , Telangana 501510,  
India  
Lat N 17° 12' 35.2224" Long E 78° 36' 46.6884"

  
PRINCIPAL  
Sri Indu Institute of Engineering & Tech.  
Sheriguda(V), Ibrahimpattam(M),  
R.R. Dist. Telangana -501 510





## Sri Indu Institute of Engineering & Technology

Recognized Under 2(f) of UGC Act 1956  
Approved by AICTE, New Delhi  
Affiliated to JNTUH, Hyderabad.



**Data Communications and Networks Lab**  
Sri Indu Institute of Engineering and Technology, Sheriguda,  
Ibrahimpattam, Nagarjuna Sagar Rd., Telangana 501510,  
India  
Lat N 17° 12' 37.3176" Long E 78° 36' 46.8684"



**Data Communications and Networks Lab**  
Sri Indu Institute of Engineering and  
Technology, Sheriguda, Ibrahimpattam, Nagarjuna  
Sagar Rd., Telangana 501510, India  
Lat N 17° 12' 35.4708" Long E 78° 36' 45.8892"

  
PRINCIPAL  
Sri Indu Institute of Engineering & Tech.  
Sheriguda(V), Ibrahimpattam(M),  
R.R. Dist. Telangana -501 510





## Sri Indu Institute of Engineering & Technology

Recognized Under 2(f) of UGC Act 1956  
Approved by AICTE, New Delhi  
Affiliated to JNTUH, Hyderabad.



Microprocessor & Microcontrollers Lab  
Sri Indu Institute of Engineering and Technology Sheriguda,  
Ibrahimpatnam, Hyderabad - Nagarjuna Sagar Rd, Telangana  
501510, India  
Lat N 17° 12' 34.8588" Long E 78° 36' 45.1224"



Microprocessor & Microcontrollers Lab  
Sri Indu Institute of Engineering and Technology Sheriguda,  
Ibrahimpatnam, Hyderabad - Nagarjuna Sagar Rd, Telangana  
501510, India  
Lat N 17° 12' 34.8408" Long E 78° 36' 45.018"

  
PRINCIPAL  
Sri Indu Institute of Engineering & Tech.  
Sheriguda(V), Ibrahimpatnam(M),  
R.R. Dist. Telangana - 501 510



# Sri Indu Institute of Engineering & Technology

Recognized Under 2(f) of UGC Act 1956  
Approved by AICTE, New Delhi  
Affiliated to JNTUH, Hyderabad.



  
**PRINCIPAL**  
Sri Indu Institute of Engineering & Tech.  
Sheriguda(V), Ibrahimpatnam(M),  
R.R. Dist. Telangana - 501 510





## Sri Indu Institute of Engineering & Technology

Recognized Under 20D of UGC Act 1956  
Approved by AICTE, New Delhi  
Affiliated to JNTU, Hyderabad.



  
PRINCIPAL  
Sri Indu Institute of Engineering & Tech.  
Sheriguda(V), Ibrahimpatnam(M),  
R.R. Dist. Telangana-501 510





# Sri Indu Institute of Engineering & Technology

Recognized Under 2(f) of UGC Act 1956  
Approved by AICTE, New Delhi  
Affiliated to JNTU, Hyderabad



  
PRINCIPAL  
Sri Indu Institute of Engineering & Tech.  
Sheriguda(V), Ibrahimpattam(M),  
R.R. Dist. Telangana -501 510



## Sri Indu Institute of Engineering & Technology

Recognized Under 2(f) of UGC Act 1956  
Approved by AICTE, New Delhi  
Affiliated to JNTU, Hyderabad.



  
PRINCIPAL  
Sri Indu Institute of Engineering & Tech.  
Shenguda(V), Ibrahimpatnam(M),  
R.R. Dist. Telangana -501 510





## Sri Indu Institute of Engineering & Technology

Recognized Under 2(f) of UGC Act 1956  
Approved by AICTE, New Delhi  
Affiliated to JNTUH, Hyderabad.



  
PRINCIPAL  
Sri Indu Institute of Engineering & Tech.  
Sheriguda(V), Ibrahimpatnam(M),  
R.R. Dist. Telangana -501 510





## Sri Indu Institute of Engineering & Technology

Recognized Under 2(f) of UGC Act 1956  
Approved by AICTE, New Delhi  
Affiliated to JNTUH, Hyderabad.

### AUDITORIUM PHOTOS



  
PRINCIPAL  
Sri Indu Institute of Engineering & Tech.  
Sheriguda(V), Ibrahimpatnam(M),  
R.R. Dist. Telangana -501 510



# Sri Indu Institute of Engineering & Technology

Recognized Under 2(f) of UGC Act 1956  
Approved by AICTE, New Delhi  
Affiliated to JNTU, Hyderabad.



  
PRINCIPAL  
Sri Indu Institute of Engineering & Tech.  
Sheriguda(V), Ibrahimpattam(M),  
R.R. Dist. Telangana -501 510





## Sri Indu Institute of Engineering & Technology

Recognized Under 2(f) of UGC Act 1956  
Approved by AICTE, New Delhi  
Affiliated to JNTUH, Hyderabad

### GIRLS HOSTEL PHOTOS



PRINCIPAL  
Sri Indu Institute of Engineering & Tech.  
Sheriguda(V), Ibrahimpatnam(M),  
R.R. Dist. Telangana -501 510